



SMART SPRINKLER CONTROLLER  
GENERATION 2

Let's get started. →

# What's in the box.



Faceplate

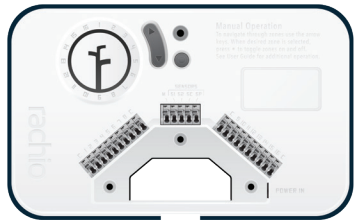

Generation 2

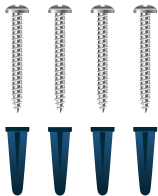

4 Screws with Anchors



Power Adapter

# What you'll need.



Wi-Fi Access  
(2.4 GHz only)



Smartphone  
or Tablet



Phillips  
Screwdriver



Hammer  
(Drywall Installs)

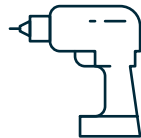

Drill and Drill Bit  
(Drywall Installs)



The Rachio Smart Sprinkler Controller, Generation 2, is designed for indoor installation. If outdoor installation is required, you'll need our weather-resistant enclosure. Learn more at [rachio.com/outdoors](https://rachio.com/outdoors).

# Need some help?



Check out our Help Center.

[support.rachio.com](https://support.rachio.com)



Give us a call.

1 (833) 722 4462



Not sure what to do with your old controller?  
We'll recycle it for free! Visit [rachio.com/recycle](https://rachio.com/recycle).

## STEP 1

# Out with the old!

Test your old system to ensure everything works properly. Photograph the wiring inside your existing controller to reference during installation. Remove your old controller from the wall.



Test  
Sprinklers



Photograph  
Wiring



Remove  
Controller

## STEP 2

# Mark screw locations.

Use the Mounting Template at the end of this guide to mark where you want to install your Generation 2.

### **For Drywall Installation:**

Drill holes at marked locations for the anchors. Use a 3/16 inch bit to drill through the drywall, then use a hammer to gently tap each anchor into place.

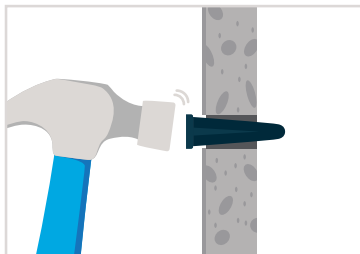
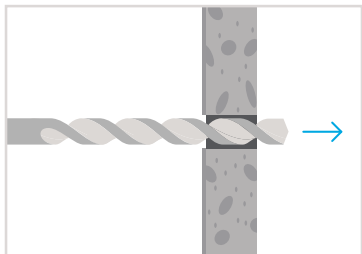

## STEP 3

# In with the new!

Remove the faceplate of the Generation 2. Mount your new controller by screwing it onto the wall using the provided screws.

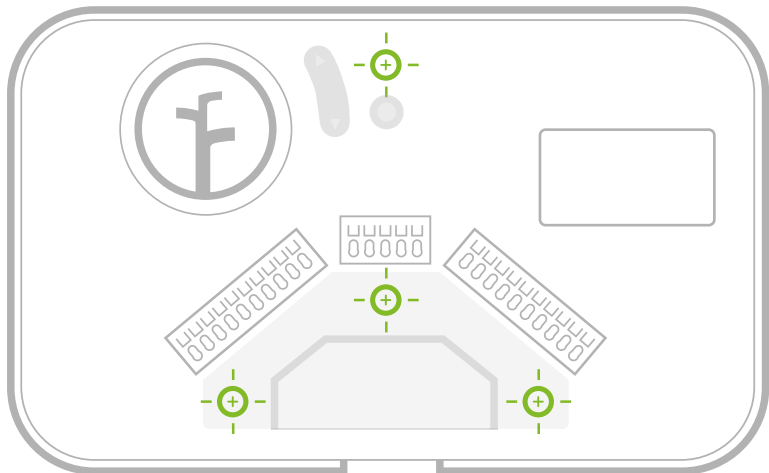



## Mounting Template

Ensure the lower holes are level, and use a pencil to mark the center of each hole.



**Make sure your wires have enough slack to reach the drill icon above!**





Tear here to detach the mounting template.

## STEP 4

# Connect your wires.

While referencing the photo of your previous wiring, insert the wires into the appropriate terminals. Things not matching up? Visit [rachio.com/wiring](https://rachio.com/wiring) for tips on advanced wiring.

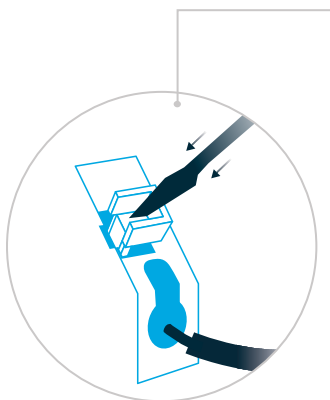

### **BEST PRACTICE: WIRING**

Insert screwdriver tip into the rectangular wire terminal.

Press in until the rectangular terminal is flush with the gray terminal bar or you feel a click.

Insert your wire, then release the rectangular terminal.

Tug the wire to make sure it is secure!

**C**

## Common Wires

Common wires are often labeled "C" or "Com." You can insert them into any of the "C" terminals.

**M**

## Master Valve

Not all systems have a master valve. Master valve wires are often labeled "M," "MV," or "Pump." If you have a master valve, wire it into the "M" terminal.

**1-16**

## Zone Wires

Zone wires correspond to your landscape's zones. Insert them into the numbered terminals.

**S1-2**

**SC**

**SP**

## Sensor Wires (Optional)

You are able to connect up to two rain or flow sensors to your controller using the "S1," "S2," and "SC" and "SP" terminals. For more information, visit [rachio.com/sensors](http://rachio.com/sensors).



Insert the power connector into the power jack located at the bottom right of the wiring bay. Then, plug the power adapter into the outlet.

## STEP 5

# Create an account.

Find the Rachio app on the Apple App Store, on Google Play, or by visiting [rachio.com/download](https://rachio.com/download). Once the app is installed, create your account.



## STEP 6

# Connect to Wi-Fi.

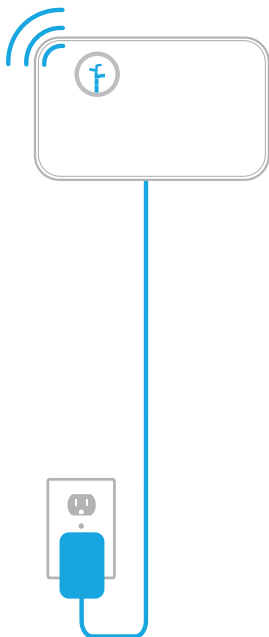

Open the Rachio app and select “Add Controller.” The app will guide you through this process.

Once your controller is online, all four blue lights will be solid. You can now replace the faceplate.

### **Don't forget!**

If you run into any issues during connection, the question mark support icon in the app can provide contextual help throughout the process!

## STEP 7

# Complete setup on the app.

Now that the controller is online, use the Rachio app to customize your zones and create a schedule.



# Congrats, you did it!

Want to learn more about what you can do with your new Generation 2?



Control your system remotely.



Integrate your smart home.



Optimize your waterings.

Visit [rachio.com/more](https://rachio.com/more).

# Manual Controls

Zones can be run directly from the controller, if needed. Use the up and down arrows to highlight a zone on the controller's lights, then press the select button.

